



SAMPLE BALLOT

& Official Voter Information Pamphlet

March 4, 2025

Special Election

To request this pamphlet in an accessible or translated format, or for voting assistance, please call 888.SMC.VOTE (888.762.8683) or email registrar@smcacre.gov.

要索取本手冊無障礙或中文版本，或需投票協助，請致電 888.SMC.VOTE (888.762.8683) 或電郵 registrar@smcacre.gov。

Upang hilingin ang pamplet na ito sa naa-akses o nakasaling format, o para sa tulong sa pagboto, mangyaring tumawag sa 888.SMC.VOTE (888.762.8683) o mag-email sa registrar@smcacre.gov.

Para solicitar este folleto en un formato accesible o traducido, o para asistencia para votar, por favor llame al 888.SMC.VOTE (888.762.8683) o envíe un correo electrónico a registrar@smcacre.gov.

This official election information is compiled and distributed by the
Office of the Chief Elections Officer & Assessor-County Clerk-Recorder
40 Tower Road, San Mateo, CA 94402 Phone: 650.312.5222 Web: smcvote.gov
Follow us on X @smcvote

1E



Notice: If the person named on the county voter information guide is not at the address, please help keep the voter rolls current and save taxpayer dollars by returning this county voter information guide to your mail carrier.

Special Election
March 4, 2025

POSTMASTER DELIVER TO:



CHANGE SERVICE REQUESTED

San Mateo County
Registration & Elections Division
40 Tower Road
San Mateo, CA 94402-4035

NONPROFIT ORG.
U.S. POSTAGE
PAID
BURLINGAME, CA
PERMIT NO. 451



Web Resources

www.smcvote.gov

SMCVOTE.gov is the San Mateo County Registration & Elections Division website, which features information on this election, voter registration, voting options and election results.

www.vote411.org/california

VOTE411.org is a comprehensive, nonpartisan online guide to federal, state and local elections in the state of California. It is a service provided by the League of Women Voters' Education Fund in partnership with U.S. Vote Foundation and Ve Y Vota.

Telephone Numbers

General Information

650.312.5222 Phone
650.312.5348 Fax

Vote Center Representative Information

650.655.6205
Information regarding Vote Center Representative applications, training and election assignments.

Disability Rights California Voting Hotline

888.569.7955
Hotline is open from 7:00 a.m. to 8:00 p.m. on Election Day, as well as before and after the election.

Language Assistance

888.SMC.VOTE (888.762.8683)
Toll-free multilingual general information (English, Chinese, Filipino and Spanish).

Telecommunications Relay Service

711
Assistive telephone relay service for people with impaired hearing.

Voting Accessibility



Each Vote Center has been surveyed and selected for accessibility. If you need additional assistance, Vote Center Representatives can assist you with curbside voting. If you are unable to travel to a Vote Center using paratransit, we will arrange and pay for your transportation within San Mateo County.

If you are unable to mark your Vote by Mail (VBM) ballot privately and independently, you may access a Remote Accessible Vote by Mail (RAVBM) ballot online at www.smcacre.gov/myelectioninfo or request voting services through our Accessible Vote at Home program for people with disabilities.

For more information, call 888.SMC.VOTE (888.762.8683) or email registrar@smcacre.gov.

Conditional Voter Registration

Missed the February 18 deadline to register to vote?

You can still vote via Conditional Voter Registration (CVR) at any Vote Center.

What's the process?

1. You will be given a paper ballot and CVR envelope.
2. Register to vote by completing the front of the CVR envelope or submitting a completed registration form.
3. Place the voted ballot in the envelope and deposit both into a Ballot Box. You must vote using a CVR ballot while inside the Vote Center.
4. If you are eligible to vote in San Mateo County and you have not already voted in this election, your CVR ballot will be counted.

SAMPLE BALLOT



SAMPLE BALLOT

SPECIAL ELECTION

TUESDAY, MARCH 4, 2025

COUNTY OF SAN MATEO

CARD A

BT-1

INSTRUCTIONS FOR VOTING:



- ONLY USE A BLACK OR DARK BLUE PEN. Do not use red ink, pencil, or any other color ink.
- To vote, completely fill in the oval to the left of your choice.
- If you make a mistake, call the Elections Office at 650.312.5222 to request another ballot, or inform a Vote Center worker.

MEASURE SUBMITTED TO THE VOTERS

COUNTY

MEASURE A

COUNTY CHARTER AMENDMENT Shall the measure amending the San Mateo County Charter to grant the Board of Supervisors authority until December 31, 2028 to remove an elected Sheriff from office for cause, including for violation of law related to a Sheriff's duties, flagrant or repeated neglect of duties, misappropriation of public funds, willful falsification of documents, or obstructing an investigation, by a four-fifths vote of the Board of Supervisors, after written notice and an opportunity to be heard, be adopted?

SUPPORTERS: Anna Eshoo, U.S. Rep; Kevin Mullin, U.S. Rep; Noelia Corzo, Supervisor; Deputy Sheriff's Assoc; Org of Sheriff's Sergeants

OPPONENTS: Dan Stegink

YES

NO

San Mateo County Charter Amendment Measure

Measure A

COUNTY CHARTER AMENDMENT Shall the measure amending the San Mateo County Charter to grant the Board of Supervisors authority until December 31, 2028 to remove an elected Sheriff from office for cause, including for violation of law related to a Sheriff's duties, flagrant or repeated neglect of duties, misappropriation of public funds, willful falsification of documents, or obstructing an investigation, by a four-fifths vote of the Board of Supervisors, after written notice and an opportunity to be heard, be adopted?

Full Text

ORDINANCE NO. 4899

BOARD OF SUPERVISORS, COUNTY OF SAN MATEO, STATE OF CALIFORNIA

* * * * *

AN ORDINANCE CALLING FOR A SPECIAL ELECTION TO BE HELD ON MARCH 4, 2025 THROUGHOUT THE COUNTY OF SAN MATEO FOR THE PURPOSE OF VOTING UPON AN AMENDMENT TO THE SAN MATEO COUNTY CHARTER GRANTING THE BOARD OF SUPERVISORS THE AUTHORITY UNTIL DECEMBER 31, 2028 TO REMOVE AN ELECTED SHERIFF FOR CAUSE, BY A FOUR-FIFTHS VOTE OF THE BOARD OF SUPERVISORS, AFTER WRITTEN NOTICE AND AN OPPORTUNITY TO BE HEARD, PROCLAIMING SAID SPECIAL LOCAL COUNTYWIDE ELECTION PURSUANT TO ELECTIONS CODE SECTION 12001, AND REQUESTING THAT THE ELECTION BE CONSOLIDATED WITH ANY AND ALL OTHER ELECTIONS TO BE HELD ON MARCH 4, 2025

The Board of Supervisors of the County of San Mateo, State of California, **ORDAINS** as follows:

WHEREAS, the County of San Mateo is one of 14 charter counties in California and has adopted the San Mateo County Charter ("Charter"), which was originally ratified by San Mateo County voters in 1932; and

WHEREAS, under the Charter, the Board of Supervisors ("Board") is the governing body of the County and, in that capacity, has all the powers and duties vested in it by the California Constitution, California general law, and the Charter, including, without limitation, the responsibility to supervise the official conduct of all County officers and employees to ensure they faithfully discharge their duties; and

WHEREAS, the Board does not currently have the authority to remove an elected Sheriff, even in cases where the Sheriff engages in such wrongdoing as the violation of laws relating to their duties, flagrant or repeated neglect of their duties, misappropriation of County funds or property, willful falsification of official statements or documents, and/or obstruction of an official investigation into the conduct of the Sheriff and/or the San Mateo County Sheriff's Office; and

WHEREAS, under the law, a Charter amendment may be proposed by the Board for approval by the voters of San Mateo County at a special election to occur on the next established election date (Cal. Const. Art. 11, § 3; Gov. Code, §§ 23720, 23722; Elec. Code, § 1000); and

WHEREAS, the Board deems it necessary and essential to submit to the qualified voters of San Mateo County the question of a proposed amendment to the Charter which, if approved, would grant the Board authority to remove an elected Sheriff from office, for cause, with a four-fifths vote, after written notice and an opportunity to be heard ("Measure"), at a special election to be held on March 4, 2025, the next established election date under the law.

SECTION 1. CALL OF ELECTION AND PURPOSE.

A special election on the Measure is hereby called, proclaimed, and ordered to be held on March 4, 2025 for the purpose of voting upon a proposed amendment to the Charter.

SECTION 2. FORM OF BALLOT QUESTION

The form of the ballot question for the Measure as it is to appear on the ballot is as follows:

COUNTY CHARTER AMENDMENT

Shall the measure amending the San Mateo County Charter to grant the Board of Supervisors authority until December 31, 2028 to remove an elected Sheriff from office for cause, including for violation of law related to a Sheriff's duties, flagrant or repeated neglect of duties, misappropriation of public funds, willful falsification of documents, or obstructing an investigation, by a four-fifths vote of the Board of Supervisors, after written notice and an opportunity to be heard, be adopted?

YES _____ NO _____

SECTION 3. THE MEASURE.

A. The Measure, if approved by voters, would add Section 412.5 to Article IV of the Charter, to read as follows:

412.5. Removal of Elected Sheriff for Cause

- a. The Board of Supervisors may remove a Sheriff from office for cause, by a four-fifths vote, after a Sheriff has been:
 - (1) Served with a written statement of alleged grounds for removal; and
 - (2) Provided a reasonable opportunity to be heard regarding any explanation or defense.
- b. For the purposes of this Section 412.5, "cause" shall mean any of the following:
 - (1) Violation of any law related to the performance of a Sheriff's duties; or
 - (2) Flagrant or repeated neglect of a Sheriff's duties as defined by law; or
 - (3) Misappropriation of public funds or property as defined in California law; or
 - (4) Willful falsification of a relevant official statement or document; or
 - (5) Obstruction, as defined in federal, State, or local law applicable to a Sheriff, of any investigation into the conduct of a Sheriff and/or the San Mateo County Sheriff's Department by any government agency (including the County of San Mateo), office, or commission with jurisdiction to conduct such investigation.
- c. The Board of Supervisors may provide for procedures by which a removal proceeding pursuant to this Section 412.5 shall be conducted.
- d. This Section 412.5 shall not be applied to interfere with the independent and constitutionally and statutorily designated investigative function of a Sheriff.
- e. This Section 412.5 shall sunset and be of no further force and effect as of December 31, 2028 unless extended by voters of San Mateo County.

San Mateo County Charter Amendment Measure

Impartial Analysis of Measure A

B. The Measure will become effective only if submitted to the voters at the Countywide special election on March 4, 2025, and only after approval by a majority (i.e., 50% + 1) of the qualified voters voting in the special election on the Measure.

C. If the Measure passes, the Charter amendment proposed by the Measure will take effect as provided for in Government Code Sections 23713 and 23714.

SECTION 4. LEGAL EFFECT OF INOPERATIVE PROVISIONS.

In the event that the amendment to the Charter contained in the Measure is rendered inoperative because of the actions of any court, legislative, or other body, or for any other reason, the provisions of the Charter in effect on March 4, 2025 will remain in full force and effect.

SECTION 5. LEGAL EFFECT OF INVALID PROVISIONS.

If any section, subsection, subdivision, paragraph, sentence, clause, phrase, or word of the Measure is for any reason held to be invalid or unenforceable, such invalidity or unenforceability will not affect the validity or enforceability of the remaining sections, subsections, subdivisions, paragraphs, sentences, clauses, phrases, or words of Section 412.5 of Article IV of the Charter. The voters of San Mateo County declare that they would have independently adopted each and every section, subsection, subdivision, paragraph, sentence, clause, phrase, or word of the Measure not declared invalid or unenforceable, without regard to whether any one or more sections, subsections, subdivisions, paragraphs, sentences, clauses, phrases, or words of Section 412.5 of Article IV of the Charter is declared invalid or unenforceable.

Approval of Measure A (“Measure”) would amend the Charter of the County of San Mateo (“Charter”) to grant the Board of Supervisors (“Board”) authority to remove an elected Sheriff from office for cause, by a four-fifths (4/5) vote of the Board. This Measure was placed on the ballot by ordinance and resolution passed by a majority vote of the Board.

The Charter currently does not give the Board authority to remove an elected Sheriff. This Measure would grant the Board with the authority to remove an elected Sheriff from office for cause after a Sheriff has been served with a written statement of the alleged grounds for removal and provided with a reasonable opportunity to be heard regarding any explanation or defense. The Measure further provides the following grounds as cause to remove an elected Sheriff:

- (1) Violation of any law related to the performance of a Sheriff’s duties;
- (2) Flagrant or repeated neglect of a Sheriff’s duties as defined by law;
- (3) Misappropriation of public funds or property as defined in California law;
- (4) Willful falsification of a relevant official statement or document; or
- (5) Obstruction, as defined in federal, State, or local law applicable to a Sheriff, of any investigation into the conduct of a Sheriff and/or the San Mateo County Sheriff’s Department by any government agency (including the County of San Mateo), office, or commission with jurisdiction to conduct such investigation.

The Board may provide procedures for how to conduct the removal proceedings. If approved by the voters, the removal for cause provisions in Section 412.5 of Article IV of the Charter shall not be applied to interfere with the independent and constitutionally and statutorily designated investigative function of a Sheriff.

The authority granted by this Measure would sunset and be of no further force and effect as of December 31, 2028 unless extended by the voters of San Mateo County.

This Measure requires approval by a majority of the qualified voters voting in the election.

San Mateo County Charter Amendment Measure

Arguments in support of or in opposition to the proposed laws are the opinions of the authors.

Argument in Favor of Measure A

Vote Yes on Measure A to hold the sheriff accountable. Our public safety is at risk — **we must act now.**

San Mateo County residents deserve leaders who uphold the law, not those who abuse their power. Measure A provides urgent checks and balances on the sheriff's office. With a built-in December 31, 2028 sunset, it is a focused and time-limited solution **to protect our community.**

Vote Yes to allow the Board of Supervisors to remove a sheriff if they commit serious violations of public trust, such as breaking the law, stealing county funds, repeatedly failing to perform official duties, falsifying documents, or obstructing justice.

Measure A responds to an independent investigative report that sustained allegations the current sheriff created a retaliatory and abusive work environment, used racial and homophobic slurs, and effectively handed control of the office to an unqualified individual with whom the sheriff had an inappropriate relationship. **These allegations could lead to millions of dollars in liabilities and lawsuits against our county.**

These actions led to mass resignations. All but one member of the executive leadership team are no longer with the department. Representatives at every level of sworn staff have united to declare no confidence in the sheriff. **How can we trust the sheriff to keep our county safe when the sheriff's own team doesn't?**

Our community deserves better leadership, accountability, and integrity.

Vote Yes on Measure A to provide common-sense checks and balances against the sheriff's unchecked authority.

Vote Yes to establish accountability and oversight for the sheriff, who oversees a \$300 million budget and is entrusted with the safety of our community.

Join San Mateo County residents, members of the sheriff's office, public safety advocates, organized labor, and community leaders in voting yes on Measure A.

There must be consequences if a sheriff violates the law and public trust.

- /s/ **Anna G. Eshoo** December 9, 2024
Member of Congress
- /s/ **Kevin Mullin** December 8, 2024
U.S. Representative
- /s/ **Noelia Corzo-Solorzano** December 9, 2024
County Supervisor
- /s/ **Sean Harper** December 9, 2024
Sheriff Sergeant, Organization of Sheriff's Sergeants
- /s/ **Matthew Silano** December 9, 2024
Deputy Sheriff, Deputy Sheriff's Association

This half page intentionally left blank

**No Rebuttal to Argument in Favor of
Measure A Submitted**

San Mateo County Charter Amendment Measure

Arguments in support of or in opposition to the proposed laws are the opinions of the authors.

Argument Against Measure A

“VOTE NO on Measure A and protect your right to vote on County Sheriff -a critical public safety role!

VOTE NO on Measure A because:

- **Measure A is a political power grab by a few local supervisors**, who seek to appoint an insider loyal to them. **It’s NOT about Good Government** and the same Supervisors just voted to pay themselves more than US Senators and even military Generals
- **Measure A is voter suppression, and strips voters of their power to elect an independent Sheriff**, turning our direct Democracy into a Bureaucracy where a few local politicians make all the rules and appoint their friends to office
- **Measure A is an illegal maneuver that will not survive a court challenge(s)**, has been falsely buttressed by multiple, intentional violations of State law, including the Ralph M. Brown open meetings act, and **will cost taxpayers up to \$9.2M**

Don’t give up your right to vote on who will best protect your family and community, Vote NO on MEASURE A!

YOUR Sheriff Christina Corpus has made great progress, including:

- **Zero homicides in 2024**
- **Rapes down 26%, burglaries down 23%, assaults down 40% and stolen property down 38%**
- **The near-elimination of catalytic converter theft that left so many hard working families, students, and seniors unable to lead their lives**

Don’t let them steal your vote and your family’s safety-

Vote NO on Measure A which weakens law enforcement and jeopardizes public safety!”

/s/ **Dan Stegink**
Rescue Diver

December 10, 2024

Rebuttal to Argument Against Measure A

Vote YES on Measure A for Accountability

Measure A is our community’s tool to restore accountability and trust by allowing the Board of Supervisors to remove the sheriff for abuse of power, unethical behavior, or gross misconduct.

A 400-page independent report reveals real problems in the sheriff’s office, including:

- **A culture of intimidation:** Staff who challenge the sheriff’s decisions or report misconduct face severe consequences, creating a culture of fear and silencing those who speak up.
- **Conflicts of interest:** The sheriff’s inappropriate relationship with her chief of staff raises grave ethical concerns and undermines the integrity of her leadership.
- **Blatant discrimination:** The sheriff has been caught making racist and homophobic remarks about the very communities she is supposed to protect, eroding trust and perpetuating harm.

Even worse, the sheriff caused the warrantless arrest of sheriff deputy and union president Carlos Tapia, who exposed corruption within the office. A thorough investigation by the district attorney’s office revealed **no legal basis for the arrest**, concluding that Deputy Tapia had **committed no wrongdoing and should never have been arrested and jailed.**

These actions are deliberate attacks on the principles of justice and accountability. The Board needs the power to remove a sheriff if it concludes these problems warrant her removal.

Vote YES on Measure A to restore integrity to the office.

Vote YES on Measure A to protect our community from lies, corruption, and abuse of power.

Vote YES on Measure A to demand leadership that works for us—not against us.

/s/ **Diane Papan** December 15, 2024
Assemblywoman

/s/ **Lisa Gauthier** December 15, 2024
East Palo Alto City Councilmember

/s/ **Eddie Flores** December 15, 2024
Mayor, South San Francisco

/s/ **Kalimah Salahuddin** December 15, 2024
Chair of Independent Civilian Advisory Commission on the Sheriff’s Office

/s/ **Gerald “Jerry” Hill** December 15, 2024
Former State Senator



Vote Center Locations

You may visit any of the following accessible Vote Centers in the County to register to vote, vote in person, return a voted ballot or request a replacement ballot. Vote Center locations are subject to change.

30-Day: February 3 to March 4

Weekdays February 3 through February 14, 7 days a week starting February 18

Redwood City	Assessor-County Clerk-Recorder	555 County Center
San Mateo	Registration & Elections Division	40 Tower Road

11-Day: Weekdays and Weekends, February 22 to March 4

Burlingame	Community Center, STEAM Lab	850 Burlingame Avenue
Daly City	Check smcvote.gov	Check smcvote.gov
Half Moon Bay	Emergency Operations Center	537 Kelly Avenue
Pacifica	Community Center, Game Room	540 Crespi Drive
San Carlos	Library, Community Room	610 Elm Street
South San Francisco	Public Library	901 Civic Campus Way

Election Day: March 4

East Palo Alto	Lewis & Joan Platt Family YMCA, Gym	550 Bell Street
Foster City	Community Center, Wind Room	1000 East Hillsdale Boulevard
Menlo Park	Arrillaga Family Recreation Center, Sequoia Room	700 Alma Street
Millbrae	David J. Chetcuti Community Room	450 Poplar Avenue
Portola Valley	Town Center, Community Hall	765 Portola Road
Redwood City	Community Activities Building, Room 1	1400 Roosevelt Avenue
San Bruno	Recreation & Aquatic Center, Classroom 1	251 City Park Way



Drop Box Locations

Indoor Locations *Availability of indoor locations is subject to the facility's operating hours.*

Atherton	80 Fair Oaks Lane	Pacifica	170 Santa Maria Avenue
-----------------	-------------------	-----------------	------------------------

24-Hour Outdoor Locations *Drive-up Drop Box

Atherton	1000 El Camino Real	Pacifica	540 Crespi Drive
-----------------	---------------------	-----------------	------------------

Belmont	1 Twin Pines Lane	Pacifica	2212 Beach Boulevard
----------------	-------------------	-----------------	----------------------

Belmont	1110 Alameda de las Pulgas	Pescadero*	1200 Pescadero Creek Road
----------------	----------------------------	-------------------	---------------------------

Brisbane	50 Park Place	Portola Valley	765 Portola Road
-----------------	---------------	-----------------------	------------------

Burlingame	501 Primrose Road	Redwood City*	403 Winslow Street
-------------------	-------------------	----------------------	--------------------

Burlingame	850 Burlingame Avenue	Redwood City	555 County Center
-------------------	-----------------------	---------------------	-------------------

Burlingame	1160 Broadway	Redwood City	1017 Middlefield Road
-------------------	---------------	---------------------	-----------------------

Colma	1198 El Camino Real	Redwood City*	1400 Roosevelt Avenue
--------------	---------------------	----------------------	-----------------------

Colma	1520 Hillside Boulevard	Redwood City	4200 Farm Hill Boulevard
--------------	-------------------------	---------------------	--------------------------

Daly City	40 Wembley Drive	San Bruno	570 Linden Avenue
------------------	------------------	------------------	-------------------

Daly City	134 Hillside Boulevard	San Bruno	1555 Crystal Springs Road
------------------	------------------------	------------------	---------------------------

Daly City	145 Lake Merced Boulevard	San Bruno*	3300 College Drive
------------------	---------------------------	-------------------	--------------------

Daly City	333 90th Street (City Hall)	San Carlos	1401 San Carlos Avenue
------------------	-----------------------------	-------------------	------------------------

Daly City*	333 90th Street (City Hall Parking Lot)	San Mateo*	40 Tower Road (Parking Lot)
-------------------	---	-------------------	-----------------------------

East Palo Alto	2415 University Avenue	San Mateo*	330 West 20th Avenue
-----------------------	------------------------	-------------------	----------------------

Foster City*	610 Foster City Boulevard	San Mateo*	725 Monte Diablo Avenue
---------------------	---------------------------	-------------------	-------------------------

Half Moon Bay	501 Main Street	San Mateo	1530 Susan Court
----------------------	-----------------	------------------	------------------

Hillsborough*	1600 Floribunda Avenue	San Mateo*	1700 West Hillsdale Boulevard
----------------------	------------------------	-------------------	-------------------------------

La Honda	8945 La Honda Road	South San Francisco	400 Grand Avenue (City Hall)
-----------------	--------------------	----------------------------	------------------------------

Menlo Park	401 Pierce Road	South San Francisco*	400 Grand Avenue (City Hall Parking Lot)
-------------------	-----------------	-----------------------------	--

Menlo Park	410 Ivy Drive	South San Francisco	901 Civic Campus Way
-------------------	---------------	----------------------------	----------------------

Menlo Park	701 Laurel Street	Woodside	2955 Woodside Road
-------------------	-------------------	-----------------	--------------------

Millbrae	621 Magnolia Avenue	Woodside	13889 Skyline Boulevard
-----------------	---------------------	-----------------	-------------------------

Additional Ballot Drop Box locations may be added. Check www.smcvote.gov for updates.



Vote by Mail

Ballots will be mailed to all registered voters by February 3.

- Voters can verify their voting status at www.smcacre.gov/myelectioninfo.
- Voted ballots can be mailed in the POSTAGE-PAID return envelope provided. Mailed ballots postmarked on or before Election Day, March 4, will be accepted if received by March 11.



Drop Off Your Voted Ballot

Voted ballots can be dropped off at a City/Town Hall, Vote Center or Ballot Drop Box in San Mateo County from February 3 until March 4 at 8:00 p.m. Outdoor Ballot Drop Boxes will be open starting February 3.

Ballot Drop Box locations can be found in this pamphlet, online at www.smcvote.gov or by calling 650.312.5222.



Vote in Person

At a Vote Center, voters can vote using a Ballot Marking Tablet or a paper ballot, get a replacement ballot or register to vote from February 3 until March 4 at 8:00 p.m.

Vote Center locations can be found in this pamphlet, online at www.smcvote.gov or by calling 650.312.5222.



Remote Accessible Vote by Mail (RAVBM) System

All registered voters can use our Remote Accessible Vote by Mail (RAVBM) system. Visit www.smcacre.gov/myelectioninfo to access the link to your RAVBM ballot and follow the instructions to ensure your vote is counted.

Mark your ballot and print it from any computer with internet access and a printer. Mail your voted ballot to San Mateo County Registration & Elections Division at 40 Tower Road, San Mateo, CA 94402 or drop off your voted ballot at any Ballot Drop Box or Vote Center.

IMPORTANT: Your ballot cannot be emailed.

The instructions below will help you securely mark and print your ballot on our accessible Ballot Marking Tablets.

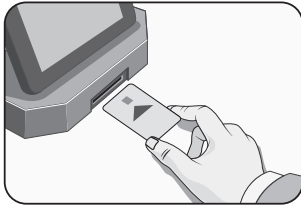

- 1** To activate your ballot, insert your **ACTIVATION CARD**, arrow side up, in the card reader at the base of the Ballot Marking Tablet. **No voter information or ballot choices are stored on the Activation Card or the tablet itself.**



Text Size



View

2

Change to preferred language, text size or screen contrast by opening the menus at the top-right corner of the screen.

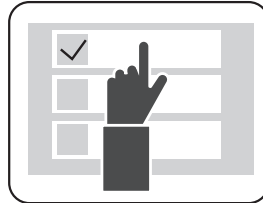

3

Make your selections by touching the box next to your choice. To make a change, un-check the box and touch the box next to your new choice. Touch **“Next”** to go to the next contest/question.

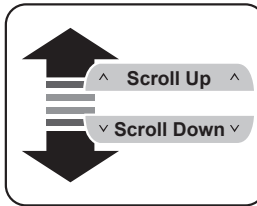

4

If additional candidates are available, you can scroll through the list by touching **“Scroll Up”** or **“Scroll Down.”**

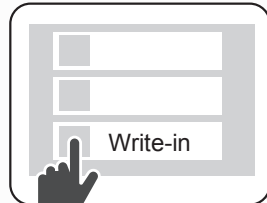

5

To vote for a Write-in Candidate, touch the box next to **“Write-in.”** A keyboard screen will display for you to enter the candidate’s name. Touch **“Accept”** when finished.

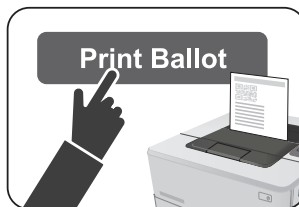

6

Once you have reviewed your selections, touch **“Print Ballot”** and your ballot will print out.

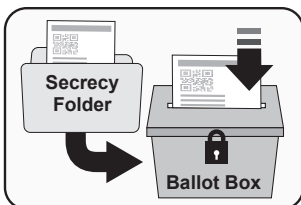

7

Place your ballot in the **Secrecy Folder** and proceed to the Ballot Box. Deposit your ballot in the Ballot Box. Return the Activation Card and Secrecy Folder to a Vote Center Representative.

Your vote is NOT cast until you place your printed ballot in the Ballot Box.



Voter Registration Update Form

Complete this form, include your signature and return it to the San Mateo County Registration & Elections Division:

- If your name is misspelled on the pamphlet's mailing label,
- If you wish to change your mailing or email address, or
- To notify us of a deceased voter in your family or household.

If you have a new name, signature, residence address or party preference, this form is not for you; you must re-register. You can re-register online at registertovote.ca.gov. Voter registration forms are also available at the San Mateo County Registration & Elections Division, local libraries, city/town halls and post offices.

Voter Registration Update

My NAME is misspelled.

The correct spelling is: _____

The incorrect spelling is: _____

I have a new MAILING ADDRESS:

Please add or update my EMAIL ADDRESS:

Please add or update my PHONE NUMBER:

Please remove my EMAIL ADDRESS:

Please remove my PHONE NUMBER:

IN ADDITION to English, I prefer to receive my voting materials in:

Burmese Chinese Filipino Hindi Japanese Korean Spanish

Notification of Deceased Voter

Deceased Voter's Name:

Your Relationship to Deceased Voter:

Deceased Voter's Date of Birth:

mm / dd / yyyy

Date of Death:

mm / dd / yyyy

VOTER INFORMATION - This box MUST be completed to fulfill your request. Please print clearly.

Your Name:

Date of Birth:

mm / dd / yyyy

Residence Address:

Phone (optional):

Signature:

Date:

Mail, fax, email or bring your completed form to:

San Mateo County Registration & Elections Division
40 Tower Road, San Mateo, CA 94402

Email: registrar@smcacre.gov
Fax: 650.312.5348