

**SAN MATEO COUNTY
CALIFORNIA VOTER'S CHOICE ACT
SUPPLEMENT TO JANUARY 2020 – JANUARY 2024
ELECTION ADMINISTRATION PLAN
FOR THE JUNE 7, 2022
STATEWIDE DIRECT PRIMARY ELECTION**



**OFFICE OF MARK CHURCH
CHIEF ELECTIONS OFFICER & ASSESSOR-COUNTY CLERK-RECORDER
REGISTRATION & ELECTIONS DIVISION
40 Tower Road, San Mateo, CA 94402
phone 650.312.5222 fax 650.312.5348
email registrar@smcacre.org web www.smcvote.org**



This page intentionally left blank

California Voter's Choice Act

Table of Contents

Overview	1
Safe Voting Options	1
<i>Vote by Mail</i>	1
<i>Vote Centers</i>	2
<i>Improved Curbside Voting</i>	2
<i>Remote Accessible Vote by Mail System</i>	3
<i>Ballot Drop Boxes</i>	3
Voter Education & Outreach	4
<i>Redistricting Communication to Voters</i>	4
<i>Filipino Language Information Postcard</i>	5
<i>Trusted Messengers</i>	6
<i>Targeting Youth</i>	6
<i>Online Appointment System</i>	7
<i>Summary of Changes to Appendix</i>	7
Vote Center Locations	8
Pop-Up Voting Locations	10
Mobile Vote Center Locations	10
Vote Center Layouts	11
Official Ballot Drop Box Locations	14
Citizen Advisory Committees	16
City Election Officials	17
New Community Partners	18
Event Calendar	18
New Media Partners	18
Postcard 1	19
Postcard 2	20
Postcard 3	21

This page intentionally left blank

Supplement to the San Mateo County Election Administration Plan for the June 7, 2022 Statewide Direct Primary Election

Overview

This supplement to the San Mateo County Election Administration Plan (EAP) for the period January 2020 through January 2024 contains plans specific to the June 7, 2022 Statewide Direct Primary Election. This document addresses changes to our EAP due to revisions to the Elections Code under the provisions of Elections Code section 3106.7 and updated local, state, and federal guidelines implemented due to the COVID-19 pandemic.

Our office continues to follow Center for Disease Control guidance and State and County Health Department COVID-19 Health Orders to ensure San Mateo County voters will have safe, secure and convenient election services. Each Vote Center will continue providing personal protective equipment and conducting regular cleaning throughout the voting period.

Assembly Bill No. 37 was signed into law on September 27, 2021, and it amended Section 3016.7 of the Elections Code to provide permanent universal access to all certified Remote Accessible Vote by Mail (RAVBM) Systems. RAVBM allows voters to use any computer with access to the internet and a printer to mark their selections and print their ballot. Voters may return their voted ballots via mail, at one of our 48 Ballot Drop Box locations or any Vote Center (including Pop-up and Mobile Centers).

Under California Elections Code section 14201, the Secretary of State, by January 1 of each year in which the Governor is elected, must determine the precincts where 3% or more of the voting-age residents are members of a “single language minority” and lack sufficient skills in English to vote without assistance. On December 8, 2021, the U.S. Census Bureau provided information on language changes throughout the country, and for San Mateo County, it was determined that more than five (5) percent of voting-age citizens are members of the Filipino language minority group and do not “speak or understand English adequately enough to participate in the electoral process...”

This means that in addition to Spanish and Chinese, official election documents will now be translated into Filipino. If someone checked the box on a voter registration form for preferring to receive election information in Filipino, they will automatically now receive a Sample Ballot & Voter Information Pamphlet and Official Ballot in Filipino. Previously, we only provided a facsimile or reference ballot in Filipino to these voters.

Safe Voting Options

Vote by Mail

Eighty-to-ninety percent of San Mateo County’s voters use the Vote by Mail ballot they receive from the Registration & Elections Division in the mail.

For the California Gubernatorial Recall Election, voters received their instructions on the steps to vote and other important information on what is called a ballot wrap. The wrap replaced the standalone three-step guide, a small four-page brochure. The wrap, folded around the ballot, is larger than the guide, allowing for bigger illustrations and more white space throughout, making it easier to read.

Following the successful trial use, the Registration & Elections Division has opted to continue to use the ballot wrap as a replacement for the three-step guide.

Vote Centers

There will be 45 Vote Centers for the Primary Election. All Vote Centers will be conveniently located throughout the county based on the Registration & Elections Division identification practices for best Vote Center locations as well as the 15 factors stated in the Voter's Choice Act and the Center of Inclusive Democracy's Voting Location Siting Tool. Vote Centers have been surveyed to confirm accessibility and that if needed, it is possible to provide 6-foot physical distancing between voters.

Vote Center Representatives (VCRs) will receive both online training and in-person training. The online training includes video components recently produced by our staff with Tenex University. While the main roles of VCRs have previously been to check-in voters and provide printed ballots or cards for voters to use the Ballot Marking Tablet, they will also be trained on mask usage and requirements. Vote Center staff will be increased to allow coverage for these additional responsibilities.

Improved Curbside Voting

To facilitate curbside voting for voters unable to enter the Vote Center, each center will have a sign for Curbside Assistance, with a bell (only heard inside), which can be activated with a tap or light touch from a vehicle's window. Upon hearing the bell, one VCR will go out with items to offer curbside voting if needed. The VCR will be equipped with a sanitized clipboard, pen and a check-in form for the voter (voter may ask to provide the information verbally to the VCR). The VCR will also have an ePollbook and a walkie-talkie to stay in contact with the Vote Center Lead and other VCRs.

Depending on the voter's preference, two people (either two staff or one staff member and the voter's assistant) will:

1. Create a Vote by Mail packet-to-go for the voter, and the ballot can be mailed, dropped off in an Official Drop Box or brought back to any Vote Center.
2. Bring a paper ballot to the voter inside a secrecy folder along with an "I Voted" sticker. Ask if the voter requires a magnifying sheet, low visibility pen or mobility grip pen. After the voter has marked their ballot, the team assisting the voter will bring the ballot, still in the secrecy folder, inside the Vote Center to deposit in the ballot box.
3. If the voter would like to use a Ballot Marking Tablet (BMT), or requires a BMT to vote independently, and is at one of the Vote Centers so equipped, including our 29-Day and 11-Day Vote Centers, as well as the Foster City and Menlo Park 4-Day Vote Centers, two people (either two staff or one staff member and the voter's assistant) can bring a BMT and printer to the vehicle. We have assembled 20 curbside carts, each being a complete portable Voting Booth. Once printed, the ballot will be cast following the return instructions above.
4. If there is not a curbside voting cart, we will inform the voter where they are available. If the voter insists on voting via BMT where they are, the Vote Center Lead will call the internal help line to request a Field Technician bring a BMT on a universal power supply out to their center. Inform voter of estimated wait time.

A Conditional Voter Registration (CVR) ballot can be issued so the voter can seal their voted ballot inside the envelope and drop it into a ballot box. The VCR would need to label the outside of the CVR envelope as a valid ballot with the date and their initials.

If the voter asks to see the ballot deposited directly into the ballot box, staff shall request the Vote Center Lead to send a newly sealed orange ballot box (first verified that it is empty and zip seal logged

in Seal Log Summary) outside (If there is only one ballot box in the Vote Center, the ballot box may not be brought outside.)

Remote Accessible Vote by Mail System

All voters can use the Remote Accessible Vote by Mail (RAVBM) System to safely access, mark and print their ballot from any computer with internet access and a printer. Voters must return a signed Oath of Voter form or sign the postage-paid return envelope provided within the Official Ballot packet. This service has been a voting option for voters with disabilities to receive and mark their ballots independently and securely. It has also provided overseas voters and military voters with a way to vote in a timely fashion. In response to the COVID-19 pandemic, this service was successfully expanded to all voters to make voting as easy and accessible as possible for the November 3, 2020 Presidential General Election.

Assembly Bill No. 37, signed into law on September 27, 2021, amended Section 3016.7 of the Elections Code to provide permanent universal access to all certified Remote Accessible Vote by Mail (RAVBM) Systems.

Ballot Drop Boxes

Beginning May 9, 2022, voters will have access to 48 Ballot Drop Box locations conveniently located throughout the county. This is a 14.2% increase from 42 Drop Boxes for the 2021 California Gubernatorial Recall Election, providing voters more convenient options to return their voted ballot.

Forty Ballot Drop Box locations are outdoors, making them accessible 24/7. Every box is secure, with indoor boxes containing security locks and fastening cables, and outdoor boxes being made of steel and bolted in-place into concrete. All Ballot Drop Boxes, and their locations, are physically accessible to voters with disabilities.

Voter Education & Outreach

Redistricting Communication to Voters

While voters will receive information in their Sample Ballot & Voter Information Pamphlet about redistricting prior to the June election, the Registration & Elections Division gave voters a first look at their own new districts with a mailing in March 2022.



OFFICE OF MARK CHURCH
CHIEF ELECTIONS OFFICER & ASSESSOR-COUNTY CLERK-RECORDER
REGISTRATION & ELECTIONS DIVISION

In accordance with Article XXI of the California Constitution and Proposition 11 (Voters FIRST Act), the State of California has redrawn the state legislative and congressional districts. The San Mateo County Board of Supervisors reviewed the new census data and officially adopted its new district boundaries and maps on December 14, 2021.

Dear Voter,

Every 10 years, following each U.S. Census, political districts are redrawn to reflect population and demographic shifts. The political districts that you vote in may have changed after the 2020 Census. Your districts, based on your residence address, are:



14th Congressional District
11th Senatorial District
18th Assembly District
1st Supervisorial District

New district maps can be found on our website, www.smcvote.org, under Redistricting. These changes will be reflected on your ballot for the June 7, 2022 election, and candidates selected will assume office in late 2022 or early 2023. Until then, your current districts and representatives remain in place.

No action is required on your part. You do not need to re-register to vote.

If you have any questions, please email us at registrar@smcacre.org, or call or text us at 650.312.5222.

MORE DAYS, MORE WAYS TO VOTE

Visit smcvote.org or   [@smcvote](https://www.instagram.com/smcvote)
Call or Text: 650.312.5222

March 2022

Filipino Language Information Postcard

This postcard (below) was mailed to approximately 600 voters. Some of the voters may have registered 20 years ago, and they may now prefer to receive their election information in English.

**OFFICE OF MARK CHURCH
CHIEF ELECTIONS OFFICER & ASSESSOR-COUNTY CLERK-RECORDER
REGISTRATION & ELECTIONS DIVISION**

**Filipino Election Materials for
June 7, 2022 Statewide Direct Primary Election**

**MORE DAYS,
MORE WAYS TO VOTE!**

I Voted
Ako Ay Bumoto
Yo Vote 我投票了
San Mateo County

The 2020 Census has shown an increase in Filipino residents in San Mateo County. To serve this growing population, all election materials will now be available in Filipino. When you registered to vote, you checked a box on your voter registration application to receive your elections information in Tagalog. We will now begin providing your election materials, including your Official Ballot and Sample Ballot & Voter Information Pamphlet, in Filipino. You will also receive a Sample Ballot & Voter Information Pamphlet in English.

If you prefer to receive your election information in a different language, please contact us. You can call or text us at 650.312.5222, email us at registrar@smcacre.org.

Kung nais ninyo ng postcard sa wikang Pilipino, mangyaring makipag-ugnayan sa amin sa 650.312.5222 o registrar@smcacre.org.

Visit smcvote.org or [@smcvote](https://twitter.com/smcvote)
Call or Text: 650.312.5222

March 2022

Some precincts in San Mateo County have reached a new high of five percent or more of their registered voters speaking Filipino. Through the 2020 U.S. Census, many Filipino speakers have been identified as limited-English proficient (LEP). While being eligible to vote, English is not their primary language, and these individuals may decide not to vote or vote without confidence due to their understanding of their English ballot. To allow LEP speakers from a number of different primary languages to actively participate in their community, there are federal and state laws applicable to language access and provisions requiring language services.

Meeting this need for Filipino language speakers, the Registration & Elections Division will provide all its official elections material in Filipino for identified precincts. This material includes required Voter's Choice Act direct contacts to voters, the County Sample Ballot & Voter Information Pamphlet and any version of the Official Ballot the voter selects, including a Vote by Mail Ballot, Remote Accessible Vote by Mail Ballot, Ballot Marking Tablet printed ballot, or a paper ballot issued at a Vote Center (or similar facility, such as the Pop-Up Voting Service and Mobile Vote Center).

The Registration & Elections Division has hired its first in-house Filipino proofreading team to review translated materials as well as be on hand to immediately translate as needed.

Our popular "I Voted" sticker was re-designed to add the slogan "I Voted" in Filipino. The sticker can be seen above on the Filipino Language postcard.

Trusted Messengers

The San Mateo County Registration & Elections Division believes that all citizens should have the power to engage in elections and have a voice in its government. To inspire greater civic participation, the Registration & Elections Division will provide the Silicon Valley Community Foundation (SVCF) with \$150,000 for the San Mateo County Voter Engagement Fund to provide grants to help increase voter engagement in the June 7, 2022 Statewide Direct Primary Election. The grants support voter engagement primarily in precincts with low voter turnout. It will be the fourth election the two organizations will work together on in making voting more accessible than ever before. The Registration & Elections Division donations now total \$510,000.

Community-Based Organizations (CBOs) have long established neighborhood ties and are recognized in their community as “trusted messengers.” This term could be defined as people community members regard as credible sources of information – credible because they have previously provided accurate information and/or they understand the concerns because they live in the same community or one very similar.

Targeting Youth

Election researchers often point to a lack of interest in voting by 18-to-24-year-olds. Reasons range from a distrust of government, a belief that their vote will not make a difference, whether it is because they think the system is corrupt or their concerns are outweighed by voters from other groups, senior citizens for instance. Young people may not see a reason to care about who is on the city council in the city they just moved to for college or any city because they are not homeowners.

Eighty-one percent of San Mateo County’s eligible voters have registered to vote. The age groups from 26 to 35, 36 to 45 and 46 to 55, each comprise just over 16% of the voters and add up to nearly 50% of the registered voters. As age increases, the group becomes a higher percent of the overall registered voters.

Currently, 2,821 young people, age 16 to 17-years-old, have pre-registered to vote. The last report on pre-registration from the Secretary of State, from July 16, 2021) estimated San Mateo County’s pre-registration at 18.11%, the highest in California. The increase from the previous report though was less than one percent, one of the few counties with under one percent growth.

While there will be no letdown on efforts to increase registration and turnout among persons with disabilities and those with limited English proficiency, the Registration & Elections Division will place a new emphasis on youth voter pre-registration, registration and turnout. The first action taken was the hiring of a high school senior to contact schools and work with other high school students. Our student has spoken or emailed in conversation with ten schools. The population of these schools total 11,500.

Our high school representative has successively asked Government teachers at two schools to give seniors ten minutes classroom time to register to vote. He has also arranged for two interviews by high school journalists with Chief Elections Officer, Mark Church. Full-time outreach staff have been in discussions with the County Youth Commission’s Civic Engagement Subcommittee about holding a poster contest, inviting students from throughout the county to create artwork which will encourage students to register to vote and/or to vote. Copies of the winning poster would be made to be distributed to all high schools in the county.

Another partnership for youth is with Daly City’s Youth Poet Laureate and Friends of the Daly City Public Library. One of the qualifications to compete is participating in at least one civic engagement activity. Madeline Hur, the first Daly City youth poet laureate, is organizing a virtual poetry event called

“Spoken Voice for Choice.” Ms. Hur is inviting her peers to share poems on youth participation in local politics, and she plans to provide registration and elections information in-between poets.

Two of the nine organizations receiving grants from the San Mateo County Voter Engagement Fund* for the June 7, 2022 Election will involve young people in their outreach programs:

- Menlo College – Campus Student Voter Turnout
- Youth Leadership Institute – Youth Engagement and Turnout.

The Registration & Elections Division Student Democracy Program is the most important program in our outreach to high school youth. The program began in 2006 and provides training for students on how to operate a Vote Center, develop civic responsibility, serve their community and foster an appreciation of the voting process.

Eighty-two percent of the students who took part in the program have said they are interested in participating in future elections as a Vote Center Representative or a Vote Center Volunteer.

Online Appointment System

The Registration & Elections Division website, smcacre.org, has a new online appointment reservation service called Qmatic. Appointments can be made to file forms to run for office, register or re-register to vote, to obtain a large number of voter registration forms for a registration effort or to observe election processes. The form confirms the area you have selected to meet and asks to include the reason for the visit. It also obtains the visitor’s email address and mobile phone number to allow the office to confirm the day and time of the visit.

Summary of Changes to Appendix

The small room Vote Center layout has been updated.

The new Vote Center locations have been marked with a star symbol for the June 7, 2022 Election.

The overall number of Official Drop Boxes has increased. There are seven new locations, marked with a star symbol, and two drop boxes have been moved to new locations in Burlingame and Pacifica.

There have been changes in the City Election Officials – two temporary City Clerks (East Palo Alto and Woodside) and two new City Clerks (Belmont and Hillsborough) in place.

Vote Center Locations

★ Star denotes a new location

29-Day Vote Centers: Weekdays, May 9 to June 7 Open Weekends/Holiday May 28 to May 30 and June 4 to 5

Redwood City	Assessor-Clerk-Recorder Divisions	555 County Center
San Mateo	Registration & Elections Division	40 Tower Road
South San Francisco	Main Library	840 West Orange Avenue

11-Day Vote Centers: Daily from May 28 to June 7

Burlingame	City Hall, Conference Room	501 Primrose Road
Daly City	Pacelli Event Center	145 Lake Merced Boulevard
East Palo Alto	Lewis and Joan Platt East Palo Alto Family YMCA	550 Bell Street
Half Moon Bay	Emergency Operations Center	537 Kelly Avenue (in Shoreline Station)
Pacifica	St. Peter Parish, Gymnasium	700 Oddstad Boulevard
San Carlos	Library Community Room	610 Elm Street

4 -Day Vote Centers: Every Day from June 4 to June 7

Atherton	Menlo College, El Camino Hall	1000 El Camino Real
Belmont	Notre Dame de Namur University, Taube Center	1500 Ralston Avenue (at Laxague Dr.)
Brisbane	City Hall, Council Chambers	50 Park Place
Burlingame ★	McKinley Elementary School	701 Paloma Avenue
Colma	Town Hall, Council Chambers	1198 El Camino Real
Daly City	Bayshore Community Center, Gym	450 Martin Street
Daly City ★	Holy Child & St. Martin Episcopal Church Hall	777 Southgate Avenue
Daly City	Lincoln Park Community Center	901 Brunswick Street
Daly City	War Memorial Community Center, Upper Gym	6655 Mission Street
East Palo Alto	East Palo Alto Academy	1050 Myrtle Street
Foster City	Community Center, Wind Room	1000 East Hillsdale Boulevard

Foster City

William E. Walker Recreation Center,
Art Gallery

650 Shell Boulevard

4-Day Vote Center Locations *continued*

Hillsborough	Town Hall, Council Chambers	1600 Floribunda Avenue
Menlo Park	Arrillaga Family Recreation Center, Sequoia Room	700 Alma Street
Menlo Park ★	Belle Haven Branch Library	413 Ivy Drive
Millbrae ★	David J. Chetcuti Community Room	450 Poplar Avenue
Moss Beach	Church of Jesus Christ of Latter-day Saints, Cultural Hall	475 California Avenue
Pacifica	Council Chambers	2212 Beach Boulevard
Portola Valley	Town Center, Community Hall	765 Portola Road
Redwood City	City Hall, Council Chambers	1017 Middlefield Road
Redwood City	Community Activities Building, Room 1	1400 Roosevelt Avenue
Redwood City	North Fair Oaks Library	2510 Middlefield Road
Redwood City	San Mateo Office of Education, California Suite	101 Twin Dolphin Drive
Redwood City ★	Woodside Fire Protection District	4091 Jefferson Avenue
San Bruno	Belle Air Elementary School, Multipurpose Room	450 3rd Avenue
San Bruno	Courtyard by Marriott SFO, Meeting Room C	1050 Bayhill Drive
San Bruno	Skyline College, Dance Room (Room 3-201) Parking Lot D	3300 College Drive
San Carlos ★	Laureola Park Community Center	503 Old County Road
San Mateo	City Hall, Conference Room C	330 West 20th Avenue
San Mateo	Congregational Church of San Mateo, Kloss Hall	225 Tilton Avenue
San Mateo	Dr. Martin Luther King, Jr. Community Center, Social B & Conference Rooms	725 Monte Diablo Avenue
San Mateo ★	Peninsula Ballet Theatre, Lobby	1880 South Grant Street (near Trader Joe's)
San Mateo	San Mateo Main Library, Oak Room	55 West 3rd Avenue
South San Francisco ★	Alice Peña Bulos Community Center, Multi-Purpose Hall	2380 Galway Drive
South San Francisco ★	Municipal Services Building, Atrium	33 Arroyo Drive
Woodside	Woodside Village Church	3154 Woodside Road

Pop-Up Voting Locations

Hours: June 6 from 9 a.m. to 5 p.m.; June 7 from 7 a.m. to 8 p.m.

East Palo Alto	University Circle	1900 University Circle	June 6 and 7
La Honda	Fire Brigade	8945 La Honda Road	June 6 and 7
Pescadero	La Honda-Pescadero Unified School District Office	360 Butano Cutoff	June 6 and 7

Mobile Vote Center Locations

Hours: June 5 to 6 from 9 a.m. to 5 p.m.; June 7 from 7 a.m. to 8 p.m.

Half Moon Bay	Half Moon Bay Airport-Eddie Andreini, Sr. Airfield	9850 N. Cabrillo Highway	June 4 and 5
San Mateo	Hillsdale Shopping Center	Parking Lot near H&M	June 6 and 7

Vote Center Layout – Small Room Example

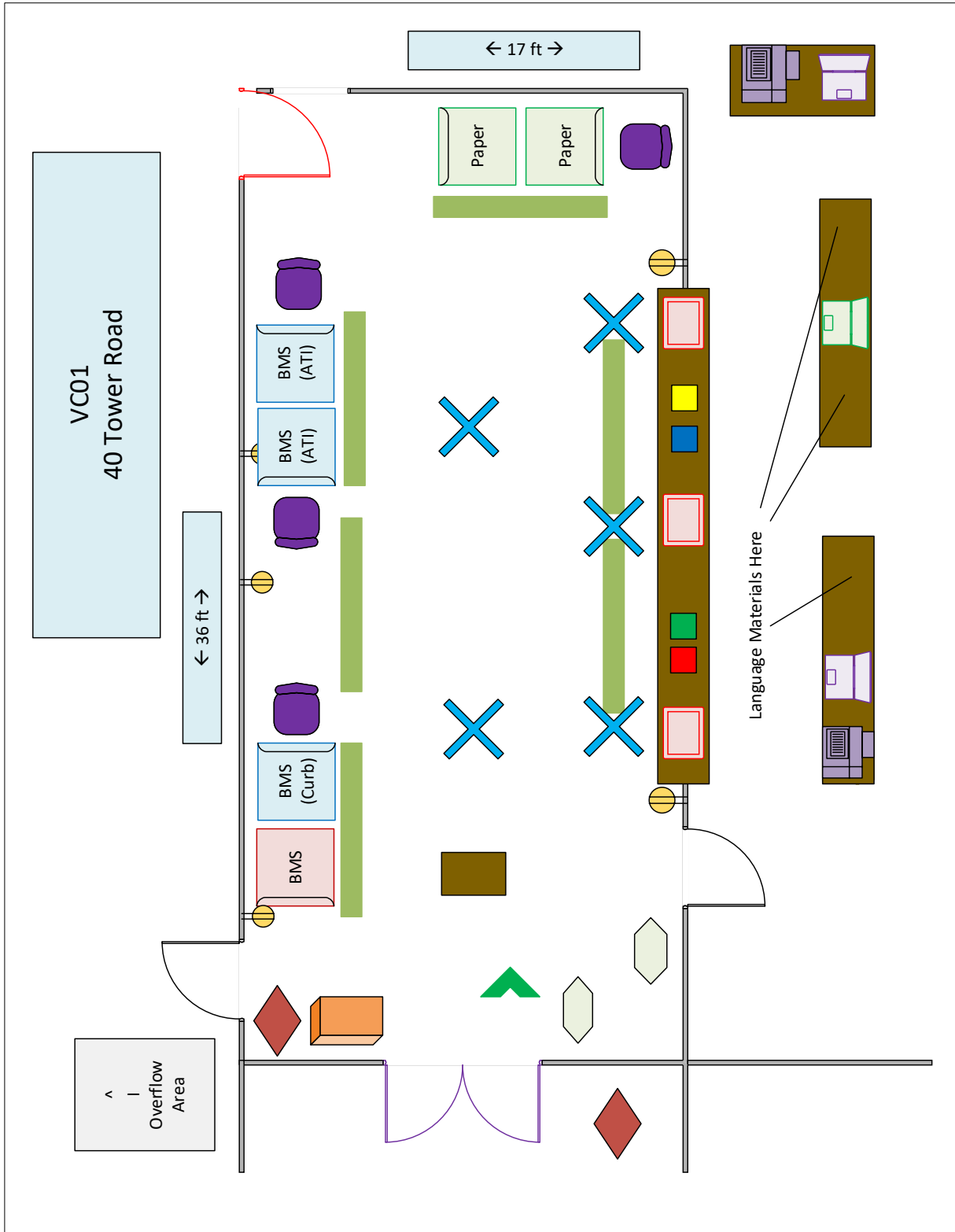

Vote Center Layout – Large Room Example

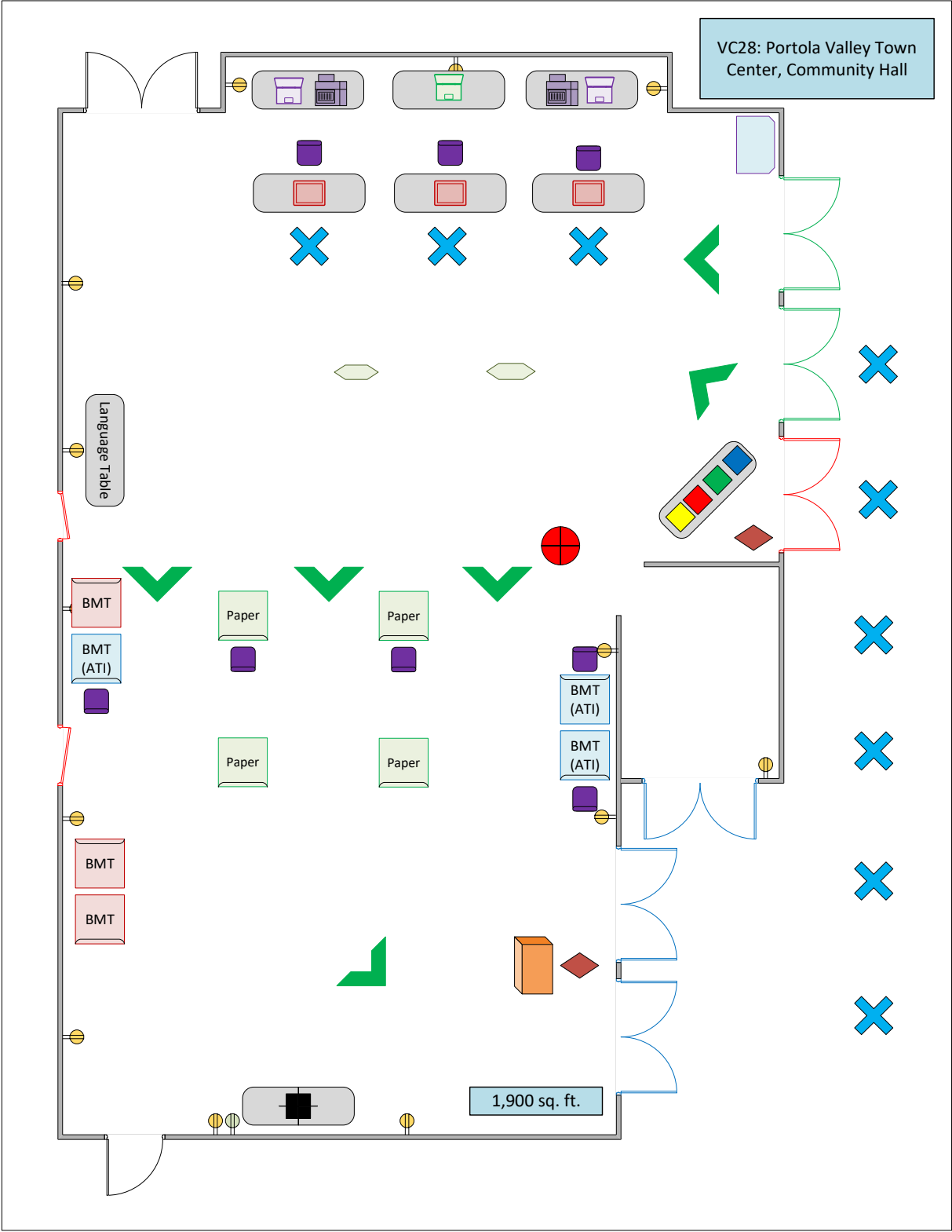

Official Ballot Drop Box Locations

★ *Star denotes a new location*

Atherton	Town Hall (inside)	80 Fair Oaks Lane
Belmont	City Hall (outside)	1 Twin Pines Lane
Belmont	Library (outside)	1110 Alameda de las Pulgas
Brisbane	City Hall (outside)	50 Park Place
Brisbane	Library (inside)	163 Visitacion Avenue
Burlingame	City Hall (outside)	501 Primrose Road
Burlingame ★	Walgreens (outside)	1160 Broadway
Colma	Community Center (outside)	1520 Hillside Boulevard
Colma	Town Hall (outside)	1198 El Camino Real
Daly City	City Hall (outside)	333 90th Street
Daly City	City Hall Parking Lot (outside)	333 90th Street
Daly City ★	Gellert Park Clubhouse (outside)	50 Wembly Drive
Daly City ★	Pacelli Event Center (outside)	145 Lake Merced Boulevard
Daly City ★	War Memorial Community Center (outside)	6655 Mission Street
East Palo Alto	Government Center (outside)	2415 University Avenue
East Palo Alto	Ravenswood City School District (inside)	2120 Euclid Avenue
East Palo Alto	University Circle (inside)	1950 University Avenue
Foster City	City Hall (outside)	610 Foster City Boulevard
Half Moon Bay	City Hall (outside)	501 Main Street
Half Moon Bay	Library (inside)	620 Correas Street
Half Moon Bay	New Leaf Community Market (inside)	150 San Mateo Road (Highway 92)
Hillsborough	Town Hall (outside)	1600 Floribunda Avenue
La Honda	Fire Brigade (outside)	8945 La Honda Road
Menlo Park ★	Belle Haven Child Development Center (outside)	410 Ivy Drive
Menlo Park	Boys & Girls Club (outside)	401 Pierce Road
Menlo Park	City Hall (outside)	701 Laurel Street
Millbrae	City Hall (outside)	621 Magnolia Avenue
Pacifica	Community Center (outside)	540 Crespi Drive

Official Ballot Drop Box Locations *continued*

Pacifica ★	Council Chambers (outside)	2212 Beach Boulevard
Pescadero	Fire Station 59 (outside)	1200 Pescadero Creek Road
Portola Valley	Town Center (outside)	765 Portola Road
Redwood City	555 County Center (outside)	Middlefield Road at Bradford Street
Redwood City	Assessor-Clerk-Recorder Divisions and Vote Center Rotunda (inside)*	555 County Center
Redwood City	City Hall (outside)	1017 Middlefield Road
Redwood City	Community Activities Building (outside)	1400 Roosevelt Avenue
Redwood City ★	County Office of Education (inside)	101 Twin Dolphin Drive
Redwood City	North Fair Oaks Library (inside)	2510 Middlefield Road
San Bruno	City Hall (outside)	570 Linden Avenue
San Bruno	Senior Center, east end of building, towards City Park (outside)	1555 Crystal Springs Road
San Carlos	City Hall Dog Park (outside)	1401 San Carlos Avenue
San Carlos	Library (inside)	610 Elm Street
San Mateo ★	City Hall (inside)	330 West 20th Avenue
San Mateo	City Hall (outside)	330 West 20th Avenue
San Mateo	Dr. Martin Luther King Jr. Center (outside)	725 Monte Diablo Avenue
San Mateo	Marina Branch Library (outside)	1530 Susan Court
San Mateo	Registration & Elections Division Vote Center (inside)*	40 Tower Road
San Mateo	Registration & Elections Division Vote Center (outside)	40 Tower Road
South San Francisco	City Hall (outside)	400 Grand Avenue
South San Francisco	City Hall Parking Lot (outside)	400 Grand Avenue
South San Francisco	Main Library & Vote Center (outside)	840 West Orange Avenue
Woodside ★	Kings Mountain Fire Brigade 56 (outside)	13889 Skyline Boulevard
Woodside	Library (inside)	3140 Woodside Road
Woodside	Town Hall (outside)	2955 Woodside Road

Citizen Advisory Committees

San Mateo County was one of the first Election departments in the state to formally establish community-based citizen advisory committees, such as the Language Accessibility Advisory Committee (LAAC), Voting Accessibility Advisory Committee (VAAC), and Voter Education and Outreach Advisory Committee (VEOAC), with the primary goal of substantially increasing voter participation and engagement amongst communities that traditionally have experienced low voter turnout in local, state, and federal elections.

The Voter Education and Outreach Program for the 2020 presidential elections faced several challenges resulting from the emerging COVID-19 pandemic. In this environment, the VEOAC proposed a new and innovative approach to Voter Education and Outreach. The recommendation was to contract with the Silicon Valley Community Foundation (SVCF) to leverage the use of public grants to contract with CBOs as trusted messengers to deliver election materials and information to hard-to-reach communities. These programs focused on reaching out to ethnic and linguistic minority communities, students, and first-time voters.

In the November 3, 2020 Presidential General Election, the program initiated more than 16,000 social media contacts, 72,000 brochure handouts and 36,000 were directly contacted via phone or text. Approximately 95,000 persons were contacted through newsletters. Nearly 100,000 households in areas with low voter registration received postcards with registration information in four languages, and over 400,000 of the County's registered voters received one or more informational postcards.

Local groups also coordinated through the SVCF to leverage their existing partnerships with local organizations to distribute multilingual information at local markets serving the Tongan, Samoan, Hispanic, Hindi, Filipino, Chinese, Japanese, Korean, and other ethnic communities. The success from using the SVCF and CBOs as trusted messengers, will be used in future elections as it resulted in impressive increases in voter participation and turnout in targeted communities.

This outreach program was recently recognized with a San Mateo County STARS Award for Equity and Inclusion Initiatives in the category of Diversity and Inclusion.

City Election Officials

Atherton
Mr. Anthony Suber
91 Ashfield Road
Atherton, CA 94027
650.752.0529
asuber@ci.atherton.ca.us

Burlingame
Ms. Meaghan Hassel-Shearer
501 Primrose Road
Burlingame, CA 94010
650.558.7203
mhasselshearer@burlingame.org

East Palo Alto (Acting City Clerk)
Mr. James Colin
2415 University Avenue
East Palo Alto, CA 94303
650.853.3118
jcolin@cityofepa.org

Hillsborough
Ms. Lisa Natusch
1600 Floribunda Avenue
Hillsborough, CA 94010
650.375.7412
lnatusch@hillsborough.net

Pacifica
Ms. Sarah Coffey
170 Santa Maria Avenue
Pacifica, CA 94044
650.738.7307
coffeys@ci.pacifica.ca.us

San Bruno
Ms. Melissa Thurman
567 El Camino Real
San Bruno, CA 94066
650.616.7058
mthurman@sanbruno.ca.gov

South San Francisco
Honorable Rosa Govea Acosta
400 Grand Avenue
P.O. Box 711
South San Francisco, CA 94083
650.877.8518
rosa.acosta@ssf.net

Belmont
Ms. Jozi Plut
One Twin Pines Lane, Suite 375
Belmont, CA 94002
650.595.7408
jplut@belmont.gov

Colma
Ms. Caitlin Corley
1198 El Camino Real
Colma, CA 94014
650.997.8311
caitlin.corley@colma.ca.gov

Foster City
Ms. Priscilla Schaus
610 Foster City Boulevard
Foster City, CA 94404
650.286.3250
clerk@fostercity.org

Menlo Park
Ms. Judi Herren
701 Laurel Street
Menlo Park, CA 94025
650.330.6621
jaherren@menlopark.org

Portola Valley
Ms. Sharon Hanlon
765 Portola Road
Portola Valley, CA 94028
650.851.1700
shanlon@portolavalley.net

San Carlos
Ms. Crystal Mui
600 Elm Street
San Carlos, CA 94070
650.802.4219
cmui@cityofsancarlos.or

Woodside
Ms. Melissa Cardinale (Interim)
2955 Woodside Road
P.O. Box 620005
Woodside, CA 94062
650.851.6790
mcardinale@woodsidetown.org

Brisbane
Ms. Ingrid Padilla
50 Park Place
Brisbane, CA 94005
415.508.2113
cityclerk@ci.brisbane.ca.us

Daly City
Honorable Annette Hipona
333 90th Street
Daly City, CA 94015
650.991.8078
ahipona@dalycity.org

Half Moon Bay
Ms. Jessica Blair
501 Main Street
Half Moon Bay, CA 94019
650.726.8271
jblair@hmbcity.com

Millbrae
Ms. Elaine Tran
621 Magnolia Avenue
Millbrae, CA 94030
650.259.2414
etran@ci.millbrae.ca.us

Redwood City
Ms. Pam Aguilar
1017 Middlefield Road
Redwood City, CA 94063
650.780.7220
paguilar@redwoodcity.org

San Mateo
Ms. Patrice Olds
330 West 20th Avenue
San Mateo, CA 94403
650.522.7042
polds@cityofsanmateo.org

New Community Partners

Casa Circulo Cultural

Faith in Action

Peninsula 360 Press

WeVoteRWC

Youth Leadership Institute

Event Calendar

In-person gatherings are still slim following the pandemic. The Registration & Elections Division has reviewed the websites for cities/towns within San Mateo County, libraries, newspapers, large community organizations and online news sites.

While we will continue to take part in events online, we will continue to look for in-person opportunities to meet potential voters, particularly in the areas of East Palo Alto, North Fair Oaks, Belle Haven and Daly City.

April 20	Spoken Voice for Choice Poems on Youth Participation in Local Politics	virtual
April 30	Children's Book Day event booth	San Bruno
Various dates	Thrive online candidate forums	including a slide on accessible voting options

New Media Partners

Bayspo Japanese Newspaper

J-Weekly Japanese Newspaper

Postcard 1



OFFICE OF MARK CHURCH
CHIEF ELECTIONS OFFICER & ASSESSOR-COUNTY CLERK-RECORDER
REGISTRATION & ELECTIONS DIVISION

June 7, 2022 Statewide Direct Primary Election
MORE DAYS, MORE WAYS TO VOTE!

Commencing May 9, 2022, ballots for the June 7, 2022 Statewide Direct Primary Election will be mailed to all registered voters. Voting by mail is safe, secure and convenient. Voters may vote from the safety and convenience of their homes, vote in person at one of our 45 Vote Centers or use our Remote Accessible Vote-by-Mail Ballot system. San Mateo County deploys the highest level of voting technology and cybersecurity practices to protect the integrity of elections. For information on new voter services and our extensive volunteer programs, please visit smcvote.org or call **650.312.5222**.

Ways to vote:



Vote by Mail



Ballot Drop Off



Vote in Person



**Remote Accessible
Vote-by-Mail Ballot System**

- May 9 to May 27 Three Vote Centers in North, Central and South County will be open weekdays, 9 a.m. to 5 p.m.
- May 28 to June 3* Nine Vote Centers will be open daily, 9 a.m. to 5 p.m.
- June 4 to June 7 Forty-five Vote Centers will be open daily, 9 a.m. to 5 p.m.
- June 7 All forty-five Vote Centers will be open, 7 a.m. to 8 p.m.

Important: Redistricting: Every 10 years, following each U.S. Census, political districts are redrawn to reflect population and demographic shifts. New district maps can be found on our website, smcvote.org

** Vote Centers will be open on Memorial Day, Monday, May 30, 2022.*

Visit smcvote.org or @smcvote
Call or Text: 650.312.5222

March 2022

This postcard was mailed to all voters on March 23 and 24.

Postcards were sent in English, Spanish, Chinese and Filipino, based on voter language preference.

Postcard 3



OFFICE OF THE
CHIEF ELECTIONS OFFICER & ASSESSOR-COUNTY CLERK-RECORDER
REGISTRATION & ELECTIONS DIVISION

June 7, 2022 Statewide Direct Primary Election

There is still time to **return your ballot!** You can mail your ballot in the postage-paid envelope, drop it off at a secure Ballot Drop Box or go to any accessible Vote Center by 8 p.m. on June 7.

If you choose to return your voted ballot by mail, it must be postmarked by Election Day, Tuesday, June 7, and received no later than June 14, 2022 to be accepted.



Didn't get a ballot? Need a new one? Need to update your address or know someone who needs to register? **Visit a Vote Center or contact our office by phone or email for assistance.**

Vote Centers offer language assistance, accessible voting equipment, curbside voting and other voter services. 45 Vote Centers will be open daily from June 4 to June 6 from 9 a.m. to 5 p.m. and Election Day, June 7 from 7 a.m. to 8 p.m.

Sign up to receive automated alerts on the status of your ballot at smcvote.org.

Please do not hesitate to contact our office should you have any questions or need any assistance. We are here to help!

Don't Delay.  Vote Today!

Visit smcvote.org or   [@smcvote](https://twitter.com/smcvote)
Call or Text: 650.312.5222

This postcard will only be sent a week prior to the election as a reminder to those who have not voted by that time.